



**LOWARA PUMPS SERIES**

 **LOWARA**  
a xylem brand



Majitec Limited whose name was derived from two words “MAJI” which means water in Kiswahili and “Tec” depicting our technological expertise was established in the year 2004.

Our unbounded passion, unmatched skill and uncompromised quality led us from one success to another and today we hold sole distributorship of quality brands in pumps and motors market and also cater to the other accessories like uPVC Pipes, Cable, Control Panel & Switch Gears sections.

### Your Trusted Provider of all innovative and cost-effective water solution

Majitec Limited is an engineering company that deals with water transportation and its related sectors. It began its operations in the year 2004 under a team composed of energetic and brilliant experts from water industry and pump manufacturing companies.

We are proud to be known as the SOLE MANUFACTURER REPRESENTATIVES of world famous brands like **xylem brand** (Lowara & Flygt), C.R.I, Varuna and Algo.

Our total solutions span from Design & Consultancy, Installation & Commissioning, Repair & Maintenance, Maintenance Contract, Plant Operations & Maintenance also Training & Technical Support provided by our skilled teams.

We provide one stop solutions to all the water industry equipment requirements such as **Pumps, Motors, Upvc Pipes, Submersibles Cables, Switch Gears and Control Panels**. We cater for all different sectors including Borehole services, Commercial Buildings, Floriculture, Irrigation, Dewatering, Sewage and Mining services.

### Vision

To be trusted and preferred provider of innovation and cost-effective total water solutions in East Africa

### Mission

MajiTec's mission is to satisfy its client's needs while upholding the technical standards of excellence and innovation. To achieve this mission, MajiTec commits to working with clients in a very individualized and responsive manner to ensure a complete understanding of the client's needs. The commitment of the energetic, professional and experienced MajiTec team focuses on offering value based services.

### Core Values

- |                    |                    |               |
|--------------------|--------------------|---------------|
| a) Integrity       | d) Team Spirit     | c) Innovation |
| b) Customer- Focus | e) Professionalism |               |

Open Impeller  
Centrifugal  
Electric  
Pumps And  
Threaded  
Connections

## CO - COM SERIES



**MARKET SECTORS**  
CIVIL, INDUSTRIAL.

### APPLICATIONS

- Washing of metal parts and/or surface treatment.
- Washing of produce in the packaging industry.
- Food industry washing equipment and systems.
- Dyeing plant and textile industry.
- Plants for the circulation and transfer of moderately viscous liquids, with light chemical aggressiveness.
- Industrial washing machines and commercial dishwashers.

### SPECIFICATIONS

#### PUMP

- **Delivery** up to 900 l/min (54 m³/h).
- **Head** up to 24 m.
- **Temperature** of pumped liquid:  
-10°C to +110°C for standard version.
- Maximum working **pressure** :  
8 bar (PN 8).
- **Suspended solids** handled up to:  
CO350: 11 mm.  
CO500: 20 mm.

#### MOTOR

- Asynchronous, squirrel cage rotor, enclosed construction in aluminium casing, external ventilation.
- **Protection**: IP55.
- Class 155 (F) **insulation**.
- Performances according to EN 60034-1.
- Maximum ambient **temperature**: 40°C.
- **Standard voltage**:
  - **Single-phase** version: 220-240 V 50 Hz, 2 poles with built-in automatic reset overload protection up to 1,5 kW. For higher powers the protection must be provided by the user.
  - **Three-phase** version: 220-240/380-415 V 50 Hz, 2 poles; overload protection to be provided by the user.
- Condensate drain plugs on all motors.

□ **All components in contact with pumped liquid are made of AISI 316L stainless steel**

□ **Mechanical seal made of Silicon carbide/tungsten carbide/FPM in the "K" version**

### CONSTRUCTION FEATURES

- Close-coupled, single-impeller centrifugal pump with axial suction and radial delivery.
- Threaded suction and delivery ports (Rp ISO 7).
- Compact construction; adaptor for motor/pump coupling; the impeller is keyed directly to the motor shaft extension.
- Back pull-out design; no need to disconnect the pump body from the system pipes.
- **AISI 316L** stainless steel open **impeller** with four pressed vanes welded onto base disk.
- Impeller's front **wear surface** consists of a sturdy **AISI 316L** stainless steel plate welded onto the suction port.
- **AISI 316L** stainless steel **pump body and seal housing disk**, with no diffusers or cavities for easier cleaning and maintenance.
- Pump body tightened by 8 screws allowing rotation of the discharge head.
- **Mechanical seal**:  
**Standard version**: **Carbon Ceramica** faces, **FPM** elastomers. The other parts are made of AISI 316L stainless steel.  
**"K" version** : faces are made of **Silicon Carbide and Tungsten Carbide**. **FPM** Elastomers. The other parts are made of AISI 316L stainless steel.
- **FPM O-Rings**.

### OPTIONAL FEATURES

- Different voltages and frequencies.
- Different materials for the mechanical seal and O-rings.



## CO350 SERIES

### HYDRAULIC PERFORMANCE TABLE AT 2850 rpm 50 Hz

PUMP TYPE	RATED POWER		Q = DELIVERY																		
	kW	HP	l/min	0	100	120	160	200	240	280	300	350	375	400	450	500	600	650	700	800	900
			m³/h	0	6	7.2	9.6	12	14.4	16.8	18	21	22.5	24	27	30	36	39	42	48	54
			H = TOTAL HEAD METERS COLUMN OF WATER																		
CO(M) 350/07	0.75	1	13.7	11.2	10.8	9.9	9.1	8.2	7.4	6.9	5.8	5.3									
CO(M) 350/09	0.9	1.2	15.7	12.7	12.2	11.3	10.5	9.6	8.8	8.3	7.2	6.6	5.9								
CO(M) 350/11	1.1	1.5	17.3	14.3	13.8	12.9	12.0	11.2	10.5	10.1	9.1	8.6	8.0	6.8							
CO(M) 350/15	1.5	2	20.3	16.9	16.4	15.3	14.4	13.5	12.7	12.2	11.2	10.6	10.0	8.7	7.2						

CO 350 Series  
Operating Characteristics At 2850 Rpm 50 Hz



Dimensions And Weights, CO 350 Series

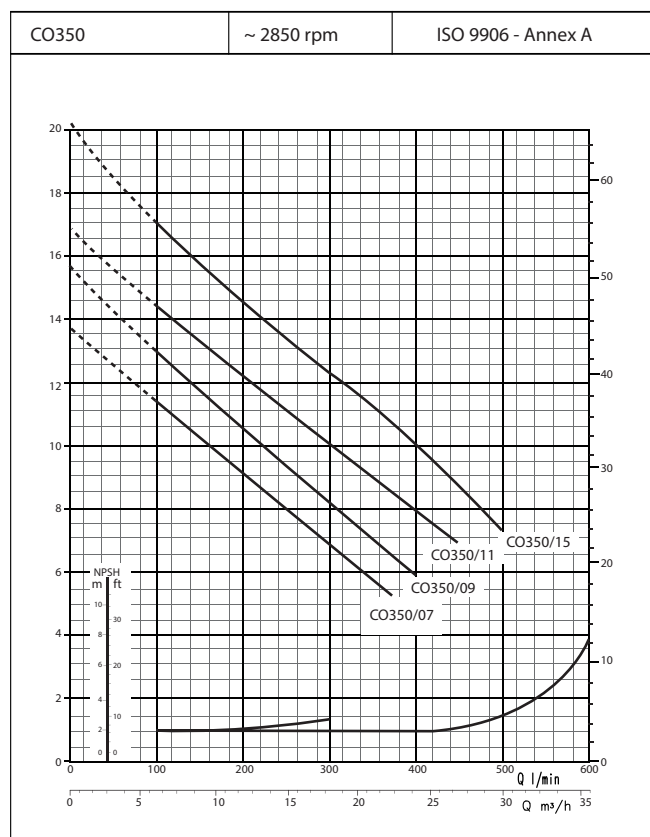
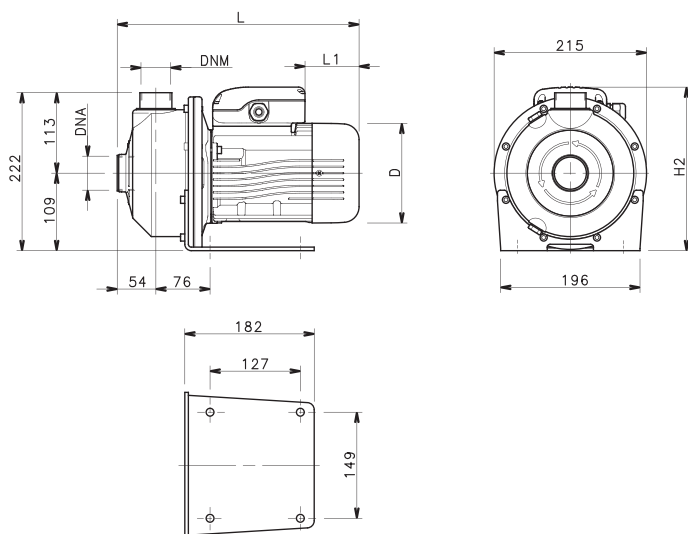

#### Electrical Data

PUMP TYPE	INPUT POWER*	INPUT CURRENT*	CAPACITOR
SINGLE-PHASE			
	<b>kW</b>	<b>220-240 V A</b>	<b>μF / 450 V</b>
COM350/07	1.02	4.67	20
COM350/09	1.21	5.46	25
COM350/11	1.75	7.85	30
COM350/15	2.04	9.21	40

PUMP TYPE	INPUT POWER*	INPUT CURRENT*	INPUT CURRENT*
THREE-PHASE			
	<b>kW</b>	<b>220-240 V A</b>	<b>380-415 V A</b>
CO 350/07	1	3.57	2.06
CO 350/09	1.13	4.21	2.43
CO 350/11	1.69	5.2	3
CO 350/15	1.98	6.3	3.64

## CO500 SERIES

### HYDRAULIC PERFORMANCE TABLE AT 2850 rpm 50 Hz

PUMP TYPE	RATED POWER		Q = DELIVERY																	
			l/min	0	100	120	160	200	240	280	300	350	375	400	450	500	600	650	700	800
	m³/h	0	6	7.2	9.6	12	14.4	16.8	18	21	22.5	24	27	30	36	39	42	48	54	
	kW	HP	H = TOTAL HEAD METERS COLUMN OF WATER																	
CO(M) 500/15	1.5	2	16.0				13.4	12.8	12.3	12.0	11.3	10.9	10.5	9.8	9.0	7.4	6.6	5.8		
CO(M) 500/22	2.2	3	19.6				17.3	16.7	16.2	15.9	15.2	14.9	14.5	13.7	13.0	11.3	10.4	9.6	7.7	
CO 500/30	3	4	24.1				20.9	20.3	19.3	19.3	18.5	18.1	17.7	16.9	16.0	14.3	13.5	12.6	10.8	9.0

### CO500 Series

#### Operating Characteristics At 2850 Rpm 50 Hz



## Dimensions And Weights, CO 500 Series

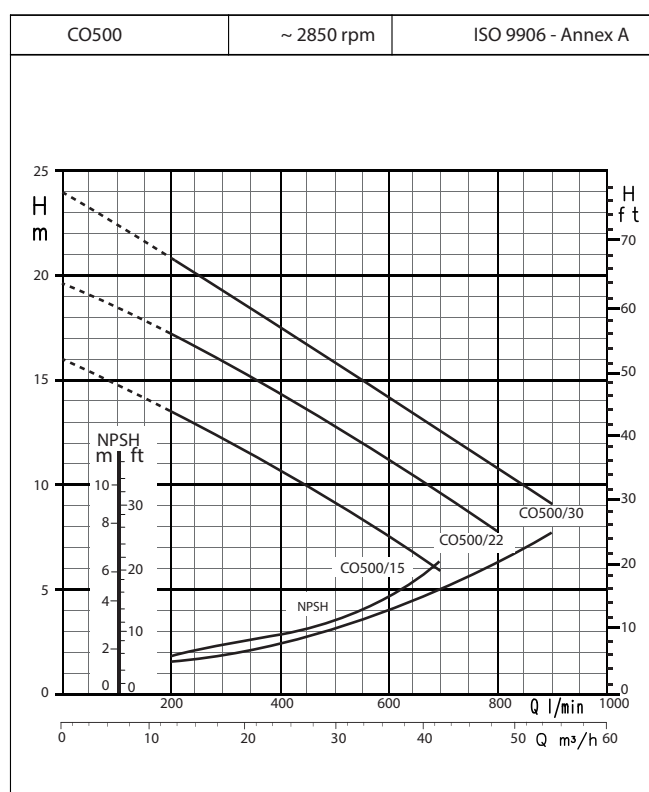
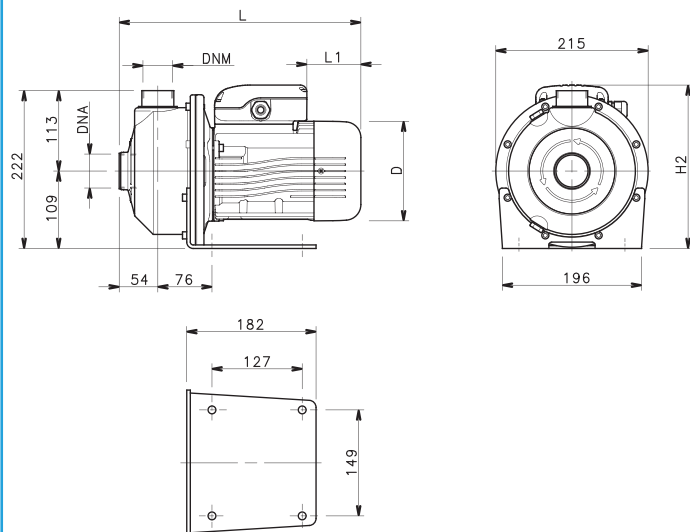

### Electrical Data

PUMP TYPE	INPUT POWER*	INPUT CURRENT*	CAPACITOR
SINGLE-PHASE	kW	220-240 V A	μF / 450 V
COM500/15	2.02	9.12	40
COM500/22	2.71	12.1	50
-	-	-	-

PUMP TYPE	INPUT POWER*	INPUT CURRENT*	INPUT CURRENT*
THREE-PHASE		220-240 V	380-415 V
	kW	A	A
C0 500/15	1.96	6.27	3.62
C0 500/22	2.73	9.06	5.23
C0 500/30	3.97	11.7	6.78

# // MAJITEC LIMITED

Beyond Water Solutions //



jt@majitec.co.ke  
sales@majitec.co.ke



+254 724 794 099  
+254 792 794 099  
+254 735 440 000



P.O. Box 27527 – 00100,  
Baba Dogo Road, Next to Dawa Ltd,  
Prabhaki Industrial Park, Godown No A4,  
Ruaraka  
Nairobi – Kenya



www.majitec.co.ke